

A banner with a teal background featuring a pattern of watermelon slices and orange slices. In the center is a white rectangular box with a green border. Inside the box, the word "SUMMER" is written in large, bold, pink capital letters, and the word "Savings" is written in a pink, cursive script font below it.

# SUMMER *Savings*

## Executive Towns Pathways

**\$4,000 Design Centre Voucher**

**or**

**5 Appliances**

**or**

**Central Air**

\* Does not apply to finished inventory. Please see sales rep for details.



# TOWNHOMES

## PATHWAYS

MODEL	OPTION	SQ.FT.	CONTEMPORARIES BLOCK 333 & 336 PRICED FROM*	CLASSIC SERIES BLOCK 332, 334 & 337 PRICED FROM*
<b>DALTON ^</b> 3 BDRM includes 280 sq.ft. finished basement		1640	518,900	514,900
<b>ADDISON</b> 3 BDRM includes 356 sq.ft. finished basement		1834	531,900	527,900
<b>GRAFTON</b> 3 BDRM includes 414 sq.ft. finished basement		1939	532,900	528,900
<b>COBALT</b> 3 BDRM includes 380 sq.ft. finished basement	(LE) **	1945	541,900	537,900
<b>HUDSON</b> 3 BDRM includes 400 sq.ft. finished basement	(LE) **	2130	553,900	549,900
<b>KENORA</b> 3 BDRM includes 335 sq.ft. finished basement	(4) **	2120	557,900	—
<b>SONOMA - CORNER LOT ONLY</b> 3 BDRM includes 353 sq.ft. finished basement, 2 car garage	(LE), (4) **	2033	558,900	554,900
<b>ODESSA</b> 3 BDRM includes 394 sq.ft. finished basement	(4) **	2209	565,900	561,900
<b>STILLWATER</b> 3 BDRM includes 508 sq.ft. finished basement		2243	567,900	563,900
<b>FAIRHAVEN</b> 3 BDRM includes 534 sq.ft. finished basement	(4) **	2539	582,900	578,900

EFFECTIVE: August 7, 2020

PRINTED: August 7, 2020

613 822 9714

pathways@richcraft.com

Lot Premiums apply on certain lots.

Subject to change without notice E.&O.E.



\*\* (LE) Signifies master bedroom with luxury ensuite = \$4,000

\*\* (4) Signifies 4th bedroom, end unit only = \$4,000

\* Any additional adjustments are subject to value added taxes.

\* Lot premiums may apply

^ Not available as an end unit



# TOWNHOME LOT PREMIUMS

## PATHWAYS

LOT #	PREMIUM	
232	20,000	end unit
237	15,000	end unit
287	25,000	oversize corner lot
290	15,000	end unit
291	15,000	end unit

EFFECTIVE: June 17, 2020

PRINTED: July 24, 2020

613 822 9714

[pathways@richcraft.com](mailto:pathways@richcraft.com)



Prices are subject to applicable value added taxes.  
Subject to change without notice E.&O.E.





# PATHWAYS

## PHASE 2 TOWNHOMES

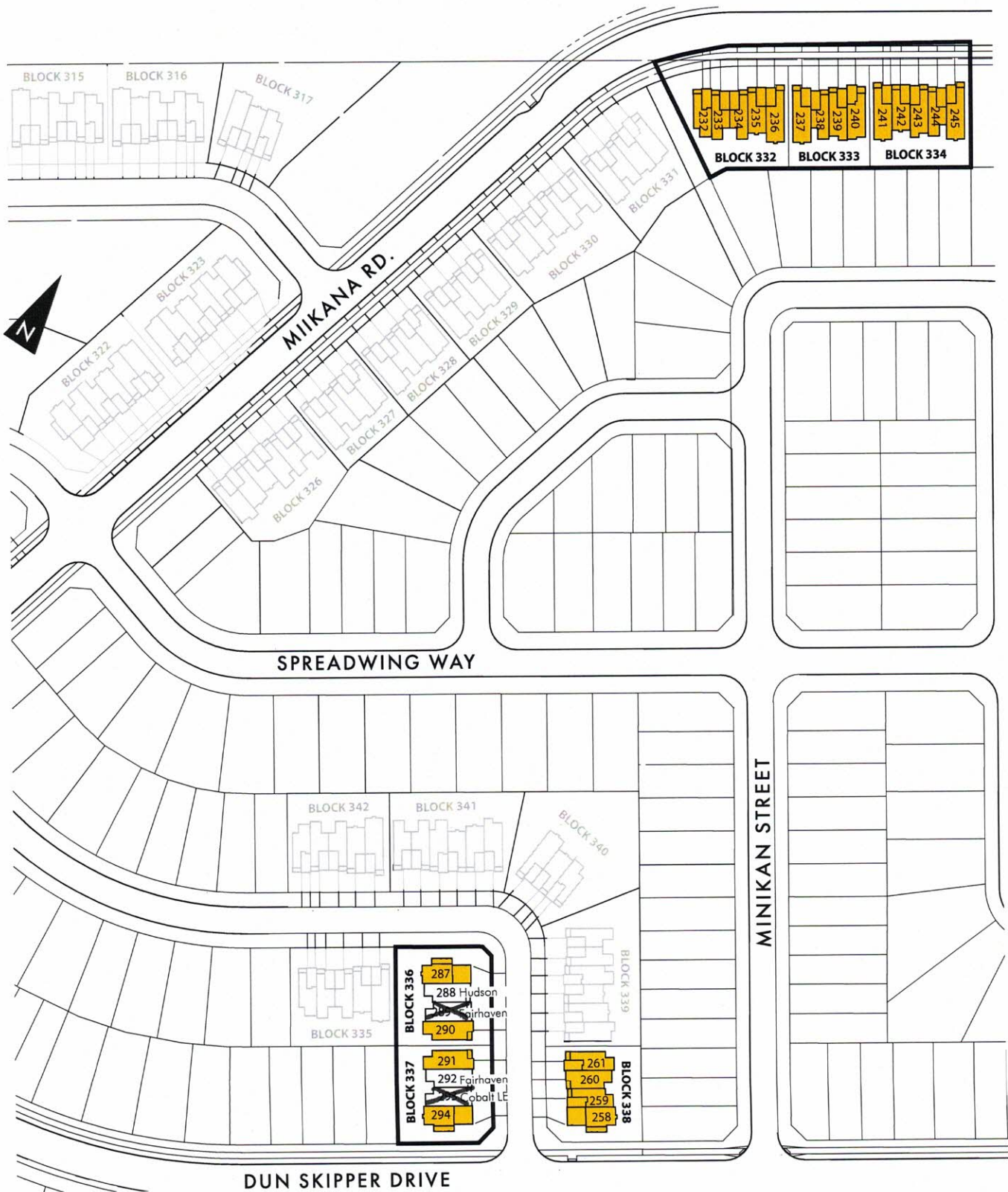

EFFECTIVE: June 17, 2020  
PRINTED: August 14, 2020

**613 822 9714**

**pathways@richcraft.com**

Lot premiums apply on certain lots.

Subject to change without notice E.&O.E.

Model restrictions apply. See sales rep for details.

