

WESTWOOD

PHASE 2 SINGLE FAMILY

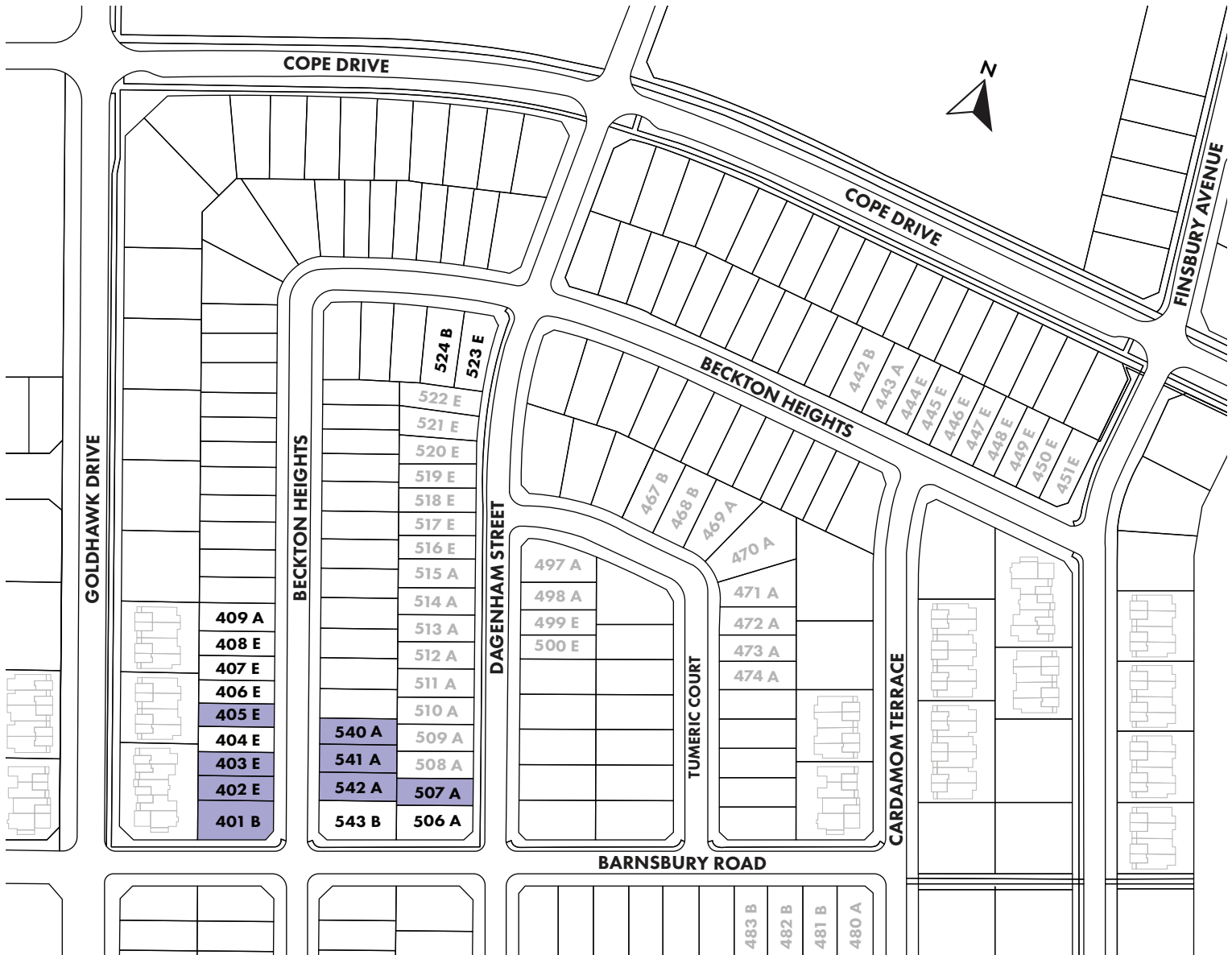

EFFECTIVE: July 13, 2021
PRINTED: Sep 10, 2021

613435 1183

westwood@richcraft.com

Lot premiums apply on certain lots.

Subject to change without notice E.&O.E

Model restrictions apply. See sales rep for details.

LOT SIZES

E - 31'

A - 35'

B - 44'

C - 50'



SINGLE FAMILY

LOT PREMIUMS AND CLOSING DATES

WESTWOOD

| LOT # | CLOSING DATE | PREMIUM | |
|-------|--------------------|---------------|---|
| 404 | August 30, 2022 | | |
| 406 | November 1, 2022 | | |
| 407 | November 3, 2020 | | |
| 408 | November 22, 2022 | | |
| 409 | November 24, 2022 | | |
| 506 | December 1, 2022 | 25,000 | corner lot, includes masonry treatment on street side |
| 523 | October 6, 2022 | 25,000 | corner lot, includes masonry treatment on street side |
| 524 | October 4, 2022 | | |
| 543 | September 29, 2022 | 30,000 | corner lot, includes masonry treatment on street side |

EFFECTIVE: May 11, 2021
PRINTED: September 10, 2021

613 435 1183
westwood@richcraft.com



Prices are subject to applicable value added taxes.
Subject to change without notice E.&O.E.



SINGLE FAMILY 31' COLLECTION

WESTWOOD

| MODEL | ELEVATION | SQ.FT. | PRICED FROM* |
|------------|-----------|--------|--------------|
| ECHO | A,C | 1785 | 788,900 |
| PRATT | C | 1950** | 827,900 |
| | A | 1950** | 832,900 |
| SILVERPINE | C | 2105 | 832,900 |
| CANMORE | C | 2250 | 855,900 |
| BATEMAN | C | 2250** | 863,900 |
| | F | 2250** | 885,900 |
| HOBART | C | 2450 | 893,900 |
| | F | 2450 | 900,900 |

Elevation A - Craftsman Series

Elevation C & D - The Contemporaries Collection

Elevation F - The Homestead Collection

* Any adjustments are subject to value added taxes

EFFECTIVE: April 26, 2021

PRINTED: July 12, 2021

613 435 1183

westwood@richcraft.com



Lot Premiums apply on certain lots.
Subject to change without notice E.&O.E.



SINGLE FAMILY 35' COLLECTION

WESTWOOD

| MODEL | ELEVATION | SQ.FT. | PRICED FROM* |
|----------|-----------|--------|--------------|
| EDWARD | C | 1740 | 845,900 |
| WATSON | A,C | 1840 | 864,900 |
| LAURENCE | A,C | 1910 | 872,900 |
| COLE | A,C | 2150 | 906,900 |
| ARDEN | A,C | 2305 | 919,900 |
| BALDWIN | C | 2680** | 946,900 |
| | D | 2680** | 958,900 |
| SPENCER | C | 2770** | 942,900 |
| | D | 2770** | 948,900 |
| | F | 2770** | 951,900 |
| MARATHON | C | 2725 | 952,900 |
| WINGATE | C,D | 2820 | 991,900 |
| | F | 2820 | 996,900 |

Elevation A - Craftsman Series

Elevation D - The Contemporaries Collection

Elevation F - The Homestead Collection

** Square footage includes open space

* Any adjustments are subject to value added taxes

EFFECTIVE: April 26, 2021

PRINTED: July 12, 2021

613 435 1183

westwood@richcraft.com



Lot Premiums apply on certain lots.
Subject to change without notice E.&O.E.



SINGLE FAMILY 44' COLLECTION

WESTWOOD

| MODEL | ELEVATION | SQ.FT. | PRICED FROM* |
|-------------|-----------|--------|--------------|
| SPRUCERIVER | A,C | 2268 | 994,900 |
| BEECHSIDE | A | 2472 | 1,021,900 |
| | C | 2472 | 1,031,900 |
| CEDARBREEZE | A | 2658 | 1,039,900 |
| | C | 2658 | 1,043,900 |
| ASHMORE | A | 2628 | 1,037,900 |
| | C | 2659 | 1,043,900 |
| NORWOOD | A | 2864 | 1,045,900 |
| | C | 2832 | 1,054,900 |
| WESTBROOK | C | 3078 | 1,087,900 |
| | F | 3078 | 1,103,900 |
| PINEFIELD | A | 3060 | 1,093,900 |
| | C | 3060 | 1,099,900 |
| MILLWOOD | C | 3230** | 1,104,900 |

Elevation A - Craftsman Series

Elevation C - The Contemporaries Collection

Elevation F - The Homestead Collection

** Square footage includes open space

* Any adjustments are subject to value added taxes

EFFECTIVE: May 11, 2021

PRINTED: July 12, 2021

613 435 1183

westwood@richcraft.com



Lot Premiums apply on certain lots.
Subject to change without notice E.&O.E.

